

FLOOR PLANS CAPACITY CHARTS

THE WESTIN
HARBOUR CASTLE
TORONTO



MEETING SPACE OVERVIEW, PART ONE

1 Harbour Square
Toronto, Ontario M5J 1A6 Canada
T 416.869.1600 F 416.869.9605
E torontomarketsales@starwoodhotels.com
westinharbourcastle.com

THE WESTIN
HARBOUR CASTLE
TORONTO

MAIN BUILDING, CONVENTION LEVEL

1. HARBOUR BALLROOM
2. HARBOUR FOYER
3. PIER 2
4. PIER 3
5. PIER 4
6. PIER 5
7. PIER 6
8. PIER 7
9. PIER 8
10. PIER 9
11. THE LAKEVIEW TERRACE

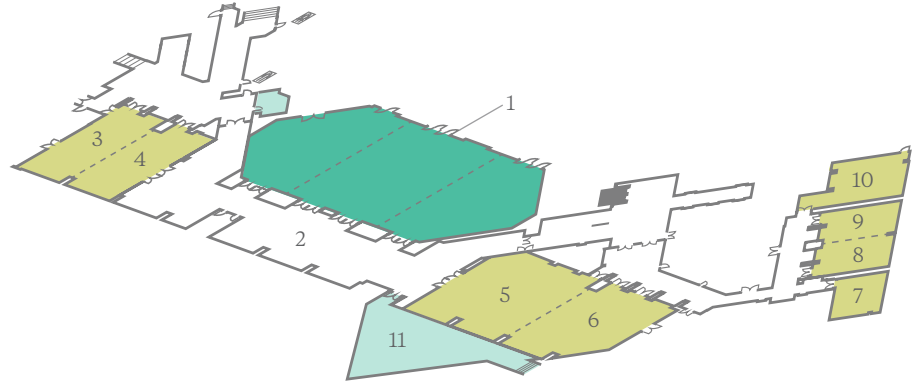

MAIN BUILDING, LOBBY LEVEL

1. MARINE ROOM
2. CHARTROOM LOUNGE
3. REGATTA
4. SAVOURY
5. MIZZEN



MAIN BUILDING, LOWER LEVEL

1. DOCKSIDE 1
2. DOCKSIDE 2
3. DOCKSIDE 3
4. DOCKSIDE 4
5. DOCKSIDE 5
6. DOCKSIDE 6
7. DOCKSIDE 7
8. DOCKSIDE 8
9. DOCKSIDE 9

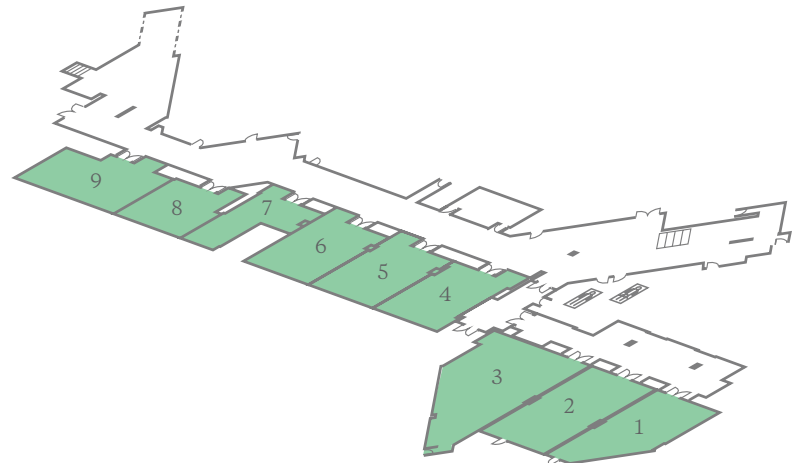

ROOMS AT A GLANCE

TOTAL GUEST ROOMS	977
TOTAL MEETING ROOMS	33
LARGEST MEETING ROOM CAPACITY	3,000
LARGEST MEETING ROOM SIZE	2,322 m ² / 24,990 ft ²

Additional spaces for meetings and events, not displayed here, may also be available. Contact your hotel representative for more information.

MEETING SPACE OVERVIEW, PART TWO

1 Harbour Square
 Toronto, Ontario M5J 1A6 Canada
 T 416.869.1600 F 416.869.9605
 E torontomarketsales@starwoodhotels.com
 westinharbourcastle.com

THE WESTIN
HARBOUR CASTLE
 TORONTO

CONFERENCE CENTRE, SECOND FLOOR

1. METROPOLITAN BALLROOM
2. METROPOLITAN BALLROOM FOYER
3. EAST WING

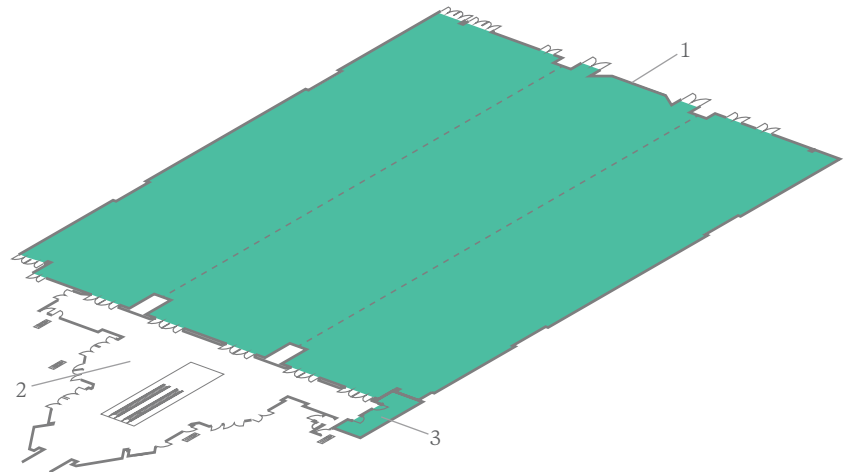

CONFERENCE CENTRE, STREET LEVEL

1. FRONTENAC BALLROOM
2. STAGE
3. FRONTENAC FOYER
4. QUEENS QUAY
5. BAY
6. WELLINGTON
7. YONGE
8. RICHMOND

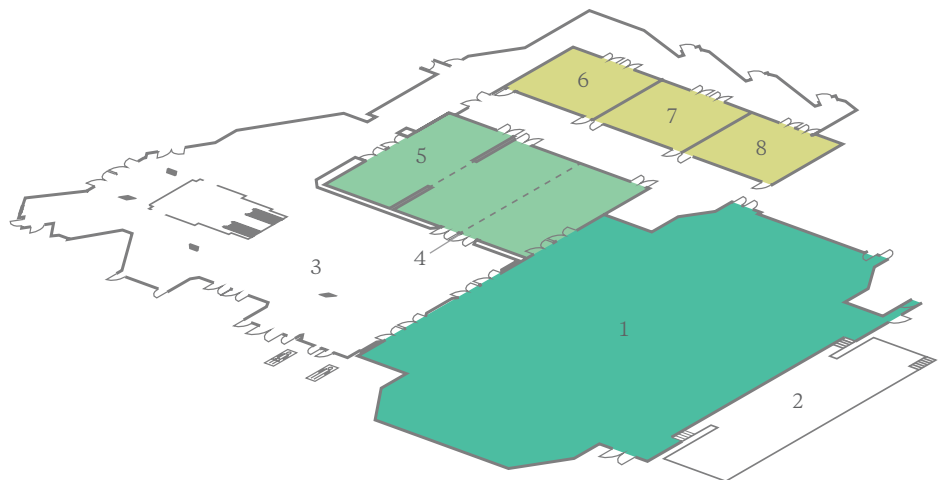

ROOMS AT A GLANCE

TOTAL GUEST ROOMS	977
TOTAL MEETING ROOMS	33
LARGEST MEETING ROOM CAPACITY	3,000
LARGEST MEETING ROOM SIZE	2,322 m ² / 24,990 ft ²

Additional spaces for meetings and events, not displayed here, may also be available. Contact your hotel representative for more information.

MEETING SPACE MAIN BUILDING CONVENTION LEVEL

1 Harbour Square
Toronto, Ontario M5J 1A6 Canada
T 416.869.1600 F 416.869.9605
E torontomarketsales@starwoodhotels.com
westinharbourcastle.com

THE WESTIN
HARBOUR CASTLE
TORONTO

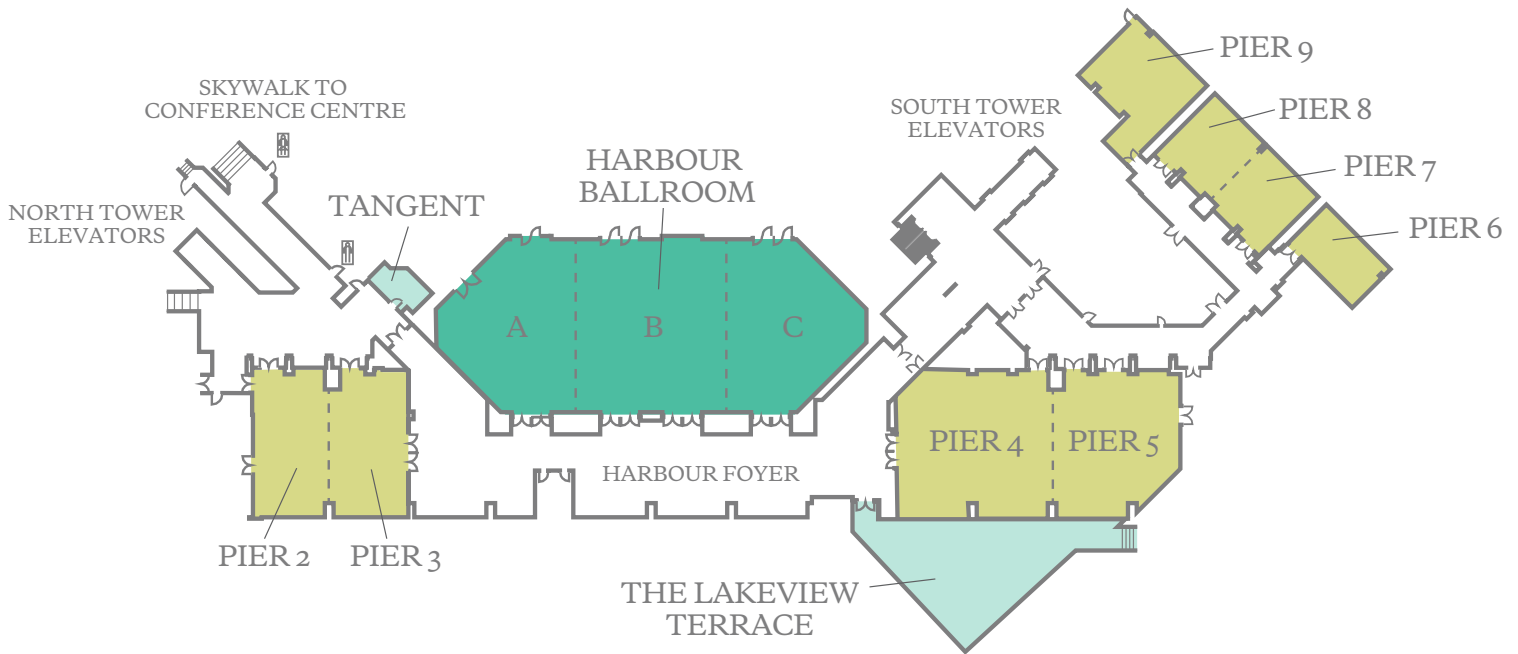

	DIMENSIONS	AREA (SQ. FT.)	MAX CEILING HEIGHT	THEATER	THEATER CHEVRON	CLASSROOM	CLASSROOM CHEVRON	BANQUET	BANQUET CHEVRON	CONFERENCE	U-SHAPE	HOLLOW SQ.	RECEPTION
HARBOUR FOYER	62' X 172'	5,217	10'	—	—	—	—	—	—	—	—	—	—
HARBOUR SALON A FOYER	62' X 60'	1,893	10'	—	—	—	—	—	—	—	—	—	—
HARBOUR SALON B FOYER	32' X 50'	1,463	10'	—	—	—	—	—	—	—	—	—	—
HARBOUR SALON C FOYER	58' X 62'	1,861	10'	—	—	—	—	—	—	—	—	—	—
■ HARBOUR BALLROOM	58' X 139'	6,920	13.1'	710	—	400	—	560	—	114	123	126	800
■ HARBOUR SALON A	58' X 45'	2,092	13.1'	200	—	100	—	150	—	42	37	52	225
■ HARBOUR SALON A - B	58' X 94'	4,857	13.1'	512	—	300	—	350	—	72	84	102	525
■ HARBOUR SALON B	58' X 49'	2,765	13.1'	300	—	150	—	200	—	42	57	76	300
■ HARBOUR SALON B - C	58' X 93'	4,825	13.1'	512	—	303	—	360	—	72	84	102	525
■ HARBOUR SALON C	58' X 45'	2,060	13.1'	200	—	100	—	150	—	42	37	54	225
■ PIER 2 - 3	49' X 51'	2,306	8.3'	200	—	90	—	140	—	46	50	54	200
■ PIER 2	48' X 25'	1,146	8.3'	100	—	30	—	60	—	28	32	40	100
■ PIER 3	49' X 26'	1,160	8.3'	100	—	30	—	60	—	28	32	40	100
■ PIER 4 - 5	48' X 95'	4,170	8.3'	325	—	160	—	250	—	90	95	106	325
■ PIER 4	48' X 51'	2,337	8.3'	180	—	96	—	140	—	46	54	64	180
■ PIER 5	48' X 44'	1,882	8.3'	130	—	84	—	110	—	40	48	54	130
■ PIER 6	17' X 30'	500	8.3'	40	—	20	—	30	—	20	22	24	30
■ PIER 7 - 8	27' X 50'	1,283	8.3'	100	—	56	—	80	—	34	40	46	100
■ PIER 7	27' X 25'	640	8.3'	45	—	24	—	40	—	16	20	24	45
■ PIER 8	27' X 25'	643	8.3'	45	—	24	—	40	—	16	20	24	45
■ PIER 9	37' X 32'	940	8.3'	75	—	30	—	50	—	25	30	36	75
■ TANGENT	12' X 19'	192	8.8'	—	—	—	—	—	—	—	—	—	20
■ THE LAKEVIEW TERRACE	52' X 89'	1,915	40'	—	—	—	—	—	—	—	—	—	—

This document contains approximate measurements and square footage that are for illustrative purposes only. We cannot guarantee the floor plan accuracy or completeness, therefore encourage you to review the space to make sure it is suitable for your event.

MEETING SPACE
MAIN BUILDING,
LOBBY LEVEL

1 Harbour Square
Toronto, Ontario M5J 1A6 Canada
T 416.869.1600 F 416.869.9605
E torontomarketsales@starwoodhotels.com
westinharbourcastle.com

THE WESTIN
HARBOUR CASTLE
TORONTO

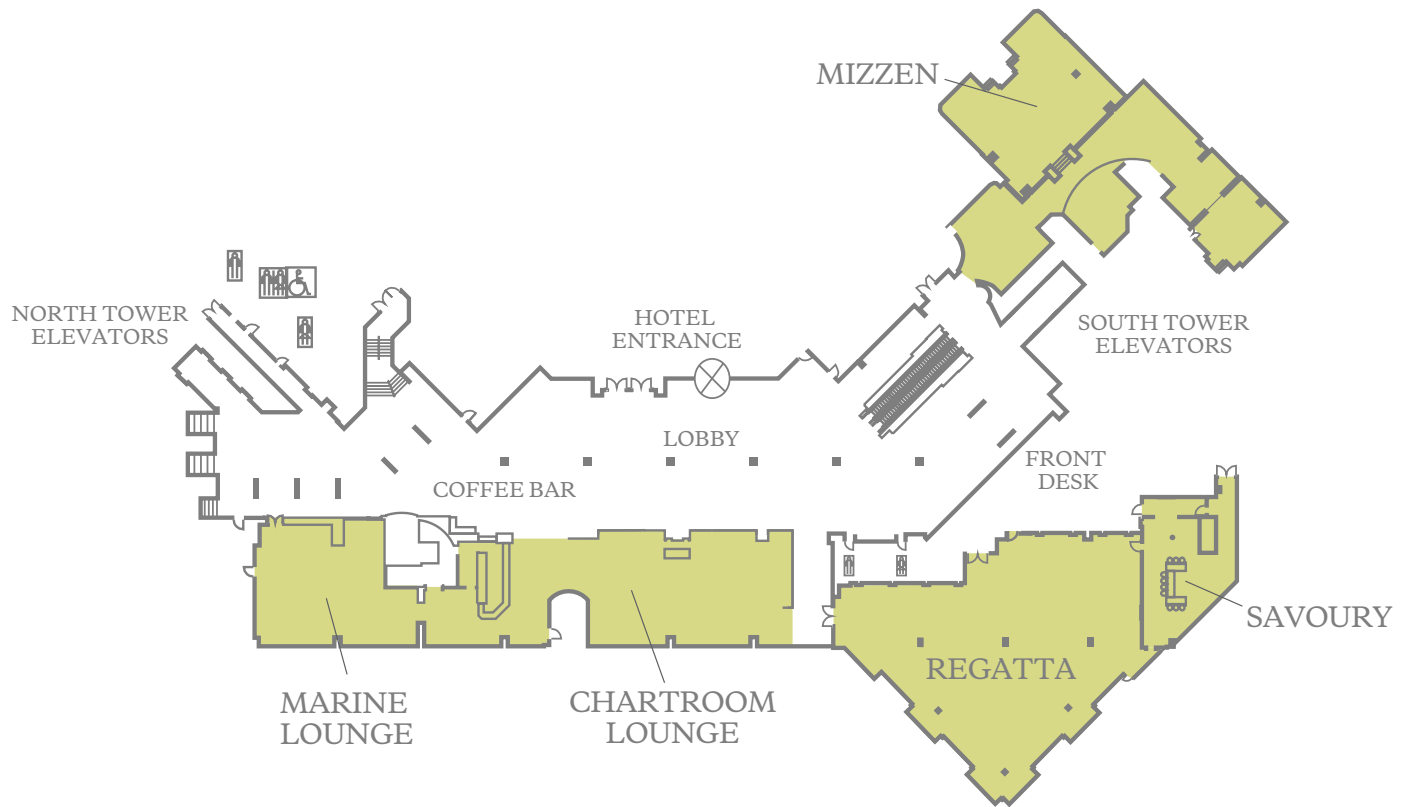

	DIMENSIONS	AREA (SQ. FT.)	MAX CEILING HEIGHT	THEATER	THEATER CHEVRON	CLASSROOM	CLASSROOM CHEVRON	BANQUET	BANQUET CHEVRON	CONFERENCE	U-SHAPE	HOLLOW SQ.	RECEPTION
■ MARINE ROOM	47' X 53'	1,914	10.2'	—	—	—	—	110	—	—	—	—	135
■ MIZZEN	84' X 100'	3,985	9.9'	—	—	—	—	—	—	—	—	—	—
■ REGATTA	100' X 84'	4,798	9'	130	—	96	—	180	—	54	33	40	210
■ SAVOURY	52' X 30'	985	10.2'	10	10	10	10	10	10	10	10	10	25

This document contains approximate measurements and square footage that are for illustrative purposes only. We cannot guarantee the floor plan accuracy or completeness, therefore encourage you to review the space to make sure it is suitable for your event.

MEETING SPACE MAIN BUILDING, LOWER LEVEL

1 Harbour Square
Toronto, Ontario M5J 1A6 Canada
T 416.869.1600 F 416.869.9605
E torontomarketsales@starwoodhotels.com
westinharbourcastle.com

THE WESTIN
HARBOUR CASTLE
TORONTO

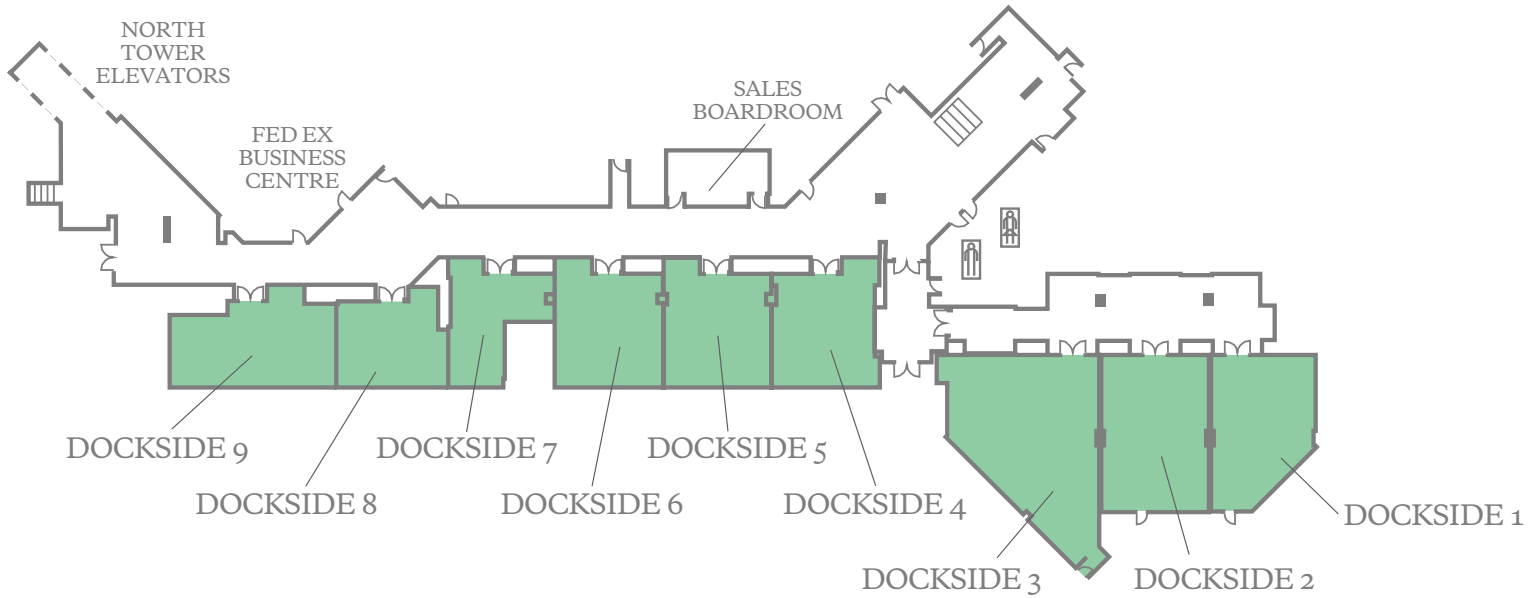

	DIMENSIONS	AREA (SQ. FT.)	MAX CEILING HEIGHT	THEATER	THEATER CHEVRON	CLASSROOM	CLASSROOM CHEVRON	BANQUET	BANQUET CHEVRON	CONFERENCE	U-SHAPE	HOLLOW SQ.	RECEPTION
■ DOCKSIDE 1	37' X 25'	795	10'	60	—	36	—	50	—	15	24	30	80
■ DOCKSIDE 2	37' X 25'	937	10'	70	—	40	—	60	—	28	33	42	95
■ DOCKSIDE 3	50' X 41'	1,322	10'	75	—	40	—	70	—	36	33	—	110
■ DOCKSIDE 4	31' X 26'	703	9.3'	60	—	24	—	40	—	18	18	24	45
■ DOCKSIDE 5	31' X 25'	710	9.5'	40	—	24	—	40	—	18	18	24	45
■ DOCKSIDE 6	31' X 24'	680	9.5'	40	—	24	—	40	—	18	18	24	45
■ DOCKSIDE 7	30' X 26'	524	9.5'	25	—	10	—	20	—	12	—	—	20
■ DOCKSIDE 8	24' X 25'	536	9.8'	30	—	18	—	30	—	18	18	24	40
■ DOCKSIDE 9	24' X 38'	761	9.9'	60	—	27	—	50	—	24	27	36	90

This document contains approximate measurements and square footage that are for illustrative purposes only. We cannot guarantee the floor plan accuracy or completeness, therefore encourage you to review the space to make sure it is suitable for your event.

MEETING SPACE CONFERENCE CENTRE, SECOND FLOOR

1 Harbour Square
Toronto, Ontario M5J 1A6 Canada
T 416.869.1600 F 416.869.9605
E torontomarketsales@starwoodhotels.com
westinharbourcastle.com

THE WESTIN
HARBOUR CASTLE
TORONTO

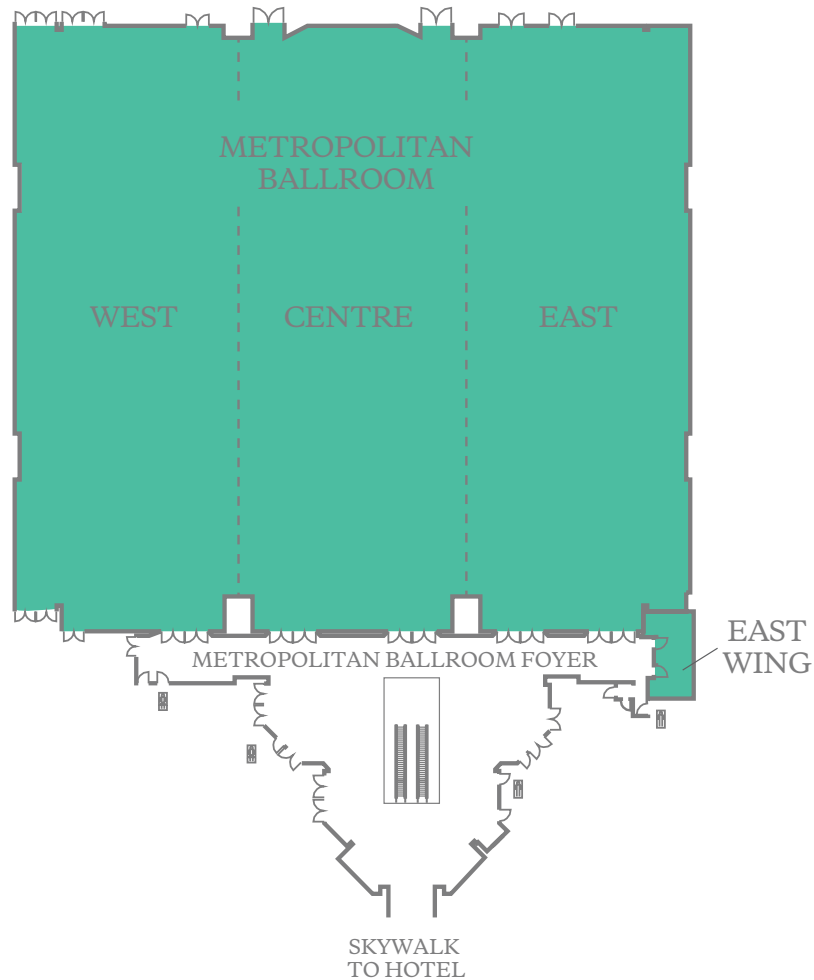

	DIMENSIONS	AREA (SQ. FT.)	MAX CEILING HEIGHT	THEATER	THEATER CHEVRON	CLASSROOM	CLASSROOM CHEVRON	BANQUET	BANQUET CHEVRON	CONFERENCE	U-SHAPE	HOLLOW SQ.	RECEPTION
■ EAST WING	26' X 39'	626	12.5'	—	—	—	—	—	—	—	—	—	50
■ METROPOLITAN BALLROOM	159' X 176'	27,426	16.9'	2,500	—	1,500	—	2,200	—	—	—	—	3,000
■ METROPOLITAN FOYER	75' X 135'	3,984	11'	—	—	—	—	—	—	—	—	—	—
■ METROPOLITAN CENTRE	159' X 59'	9,288	16.9'	900	—	540	—	800	—	—	—	—	1,100
■ METROPOLITAN CENTRE & EAST	159' X 118'	18,341	16.9'	1,804	—	1,035	—	1,400	—	—	—	—	2,000
■ METROPOLITAN EAST	158' X 58'	9,071	16.9'	820	—	540	—	690	—	—	—	—	1,000
■ METROPOLITAN WEST	159' X 58'	9,089	16.9'	820	—	540	—	690	—	—	—	—	1,000
■ METROPOLITAN WEST & CENTRE	159' X 118'	18,361	16.9'	1,804	—	1,035	—	1,400	—	—	—	—	2,000

This document contains approximate measurements and square footage that are for illustrative purposes only. We cannot guarantee the floor plan accuracy or completeness, therefore encourage you to review the space to make sure it is suitable for your event.

MEETING SPACE CONFERENCE CENTRE, STREET LEVEL

1 Harbour Square
Toronto, Ontario M5J 1A6 Canada
T 416.869.1600 F 416.869.9605
E torontomarketsales@starwoodhotels.com
westinharbourcastle.com

THE WESTIN
HARBOUR CASTLE
TORONTO

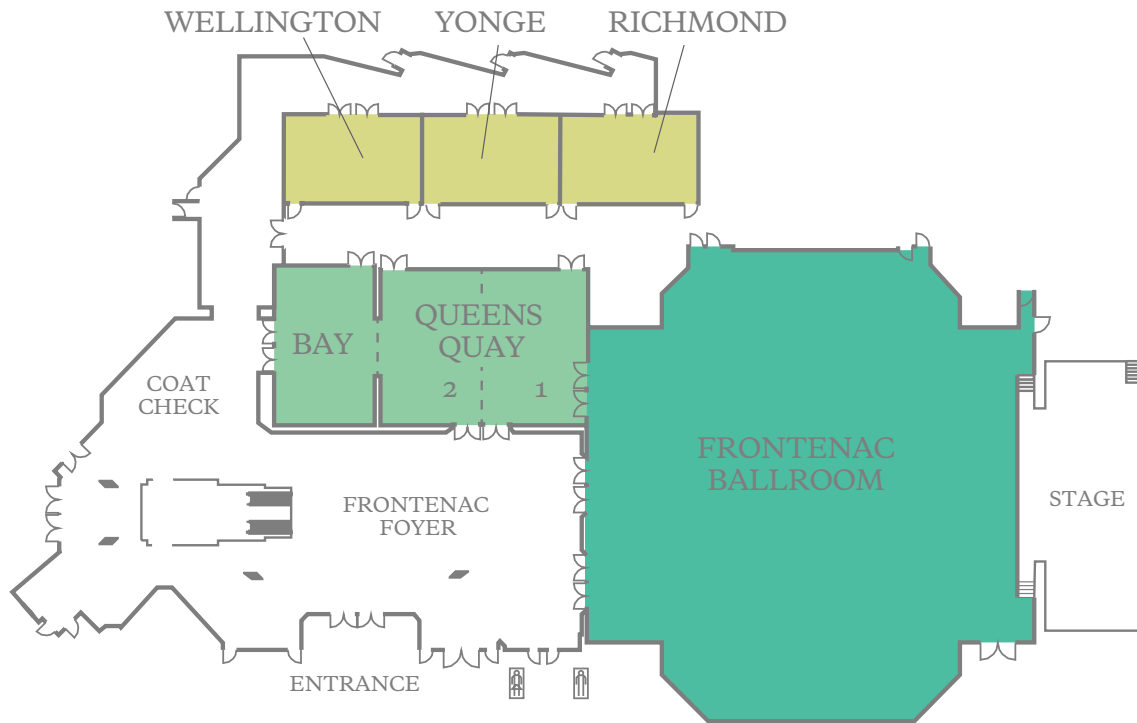

	DIMENSIONS	AREA (SQ. FT.)	MAX CEILING HEIGHT	THEATER	THEATER CHEVRON	CLASSROOM	CLASSROOM CHEVRON	BANQUET	BANQUET CHEVRON	CONFERENCE	U-SHAPE	HOLLOW SQ.	RECEPTION
■ FRONTENAC BALLROOM	101' X 108'	9,267	14'	990	—	500	—	750	—	80	110	140	1,100
■ FRONTENAC FOYER	76' X 130'	6,159	16.1'	—	—	—	—	—	—	—	—	—	—
■ BAY	24' X 37'	837	12'	80	—	36	—	60	—	28	34	40	75
■ BAY & QUEENS QUAY	36' X 70'	2,482	12'	—	—	—	—	180	—	—	—	—	255
■ QUEENS QUAY	36' X 47'	1,650	12'	180	—	75	—	120	—	40	50	56	180
■ QUEENS QUAY 2 & BAY	36' X 47'	1,658	12'	—	—	—	—	120	—	—	—	—	150
■ QUEENS QUAY 1	36' X 23'	829	12'	80	—	36	—	60	—	28	34	40	75
■ QUEENS QUAY 2	36' X 24'	823	12'	80	—	36	—	60	—	28	34	40	75
■ RICHMOND	21' X 31'	614	11.9'	52	—	20	—	30	—	25	20	24	50
■ WELLINGTON	21' X 31'	614	11.9'	52	—	20	—	30	—	25	20	25	50
■ WELLINGTON 1	21' X 15'	306	11.9'	20	—	9	—	10	—	—	—	—	25
■ WELLINGTON 2	21' X 15'	309	11.9'	20	—	9	—	10	—	—	—	—	25
■ YONGE	20' X 31'	601	11.9'	52	—	20	—	30	—	25	20	25	63
■ YONGE 1	20' X 15'	302	11.9'	20	—	9	—	10	—	—	—	—	25
■ YONGE 2	20' X 15'	299	11.9'	20	—	9	—	10	—	—	—	—	25

This document contains approximate measurements and square footage that are for illustrative purposes only. We cannot guarantee the floor plan accuracy or completeness, therefore encourage you to review the space to make sure it is suitable for your event.



1 Harbour Square
Toronto, Ontario M5J 1A6 Canada
T 416.869.1600 F 416.869.9605
E torontomarketsales@starwoodhotels.com
westinharbourcastle.com

THE WESTIN
HARBOUR CASTLE
TORONTO